

DIY Installation Guide

# Roller Shutter Door



**Gelmar**

# Roller Shutter Fittings



## Slat

Code	L	Col
360	3m	Silver
370	3m	Black

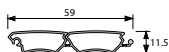

## Track

Code	L
4205	2m
4206	3m
3135	5m

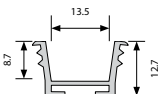

## Handle Cover

Code	L
3136	2.5m
3146	3m

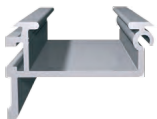
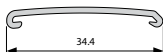

## Handle Grip

Code
3187

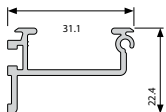

## Handle Guide

Code
3189

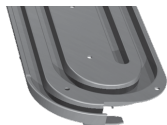

## Snail Track

Code
3188



## 90° Corner Track

Code	Qty	Col
369	4	Grey
375	4	Black

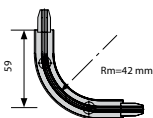

- This Handle Assembly consists of
- 1x Handle Grip
  - 1x Handle Cover
  - 2x Handle Guides
  - 1x Arch Handle

## Roller Shutter

Code	Type	L	H	W	Colour	Finish
360	Slat	3m	11.5	59	Silver	Plastic
370	Slat	3m	11.5	59	Black	Plastic
361	Track	3m			Grey	Plastic
371	Track	3m			Black	Plastic
365	Handle Cover	3m		34.4	Silver	Plastic
367	Handle Cover	1m		34.4	Silver	Plastic
374	Handle Cover	1m		34.4	Black	Plastic
364	Handle Grip	3m	22.4	31.1	Silver	Aluminium

## Pre-Pack

Code	Handle Guides	Snail Track	Black Corners	90° Corner Track	Finish
368	2	2	-	-	Plastic
369	2	-	-	4	Plastic
375	2	-	4	-	Plastic

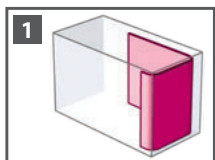

The roller shutter door can be configured to one of three possible options:

1. The door can run into the back of the cupboard where it is concealed behind a false back;

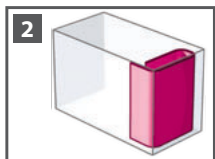

2. One door opens onto a set of Snail Tracks behind a false side;

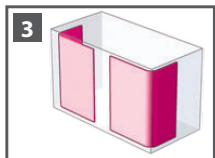

3. Two doors can close in the front middle of the cupboard.

# Preparing for Installation

## STEP 1

Measure the internal height and width of the cupboard.

Recommended Dimensions:

- The following dimensions are valid for one cabinet door.
- For cabinets with 2 doors, divide the width specified by 2.

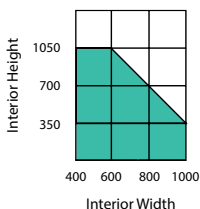
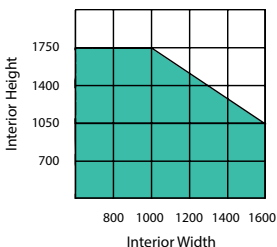
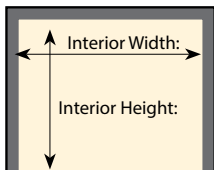

Horizontal Application

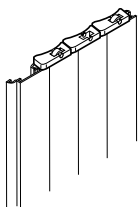

Horizontal  
↔ Sliding direction

Vertical Application

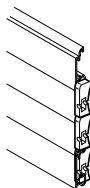

Vertical  
↑↓ Sliding direction



# Preparing for Installation

## STEP 2

### Calculate Cutting List

#### Horizontal Cabinet

Roller Shutter (360) (height)	= internal height	+ 13,5
Roller Shutter (360) (width)	= internal width	+ 30
Aluminium Handle (364)	= internal height	- 20,5
Handle Cover (365)	= internal height	+ 3,5

# Installation

## STEP 3

### Installing the Roller Shutter

#### Roller Shutter door with Snail Track

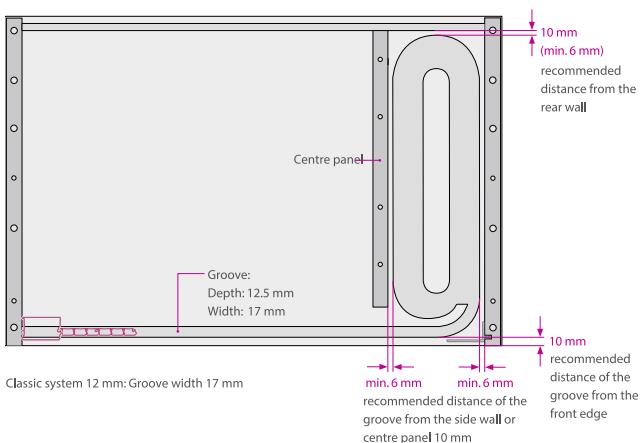
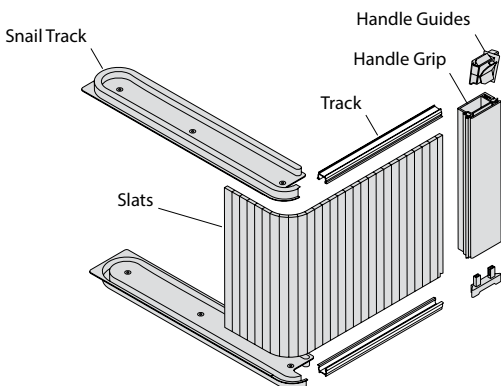

## STEP 2

### Calculate Cutting List

#### Vertical Cabinet

Roller Shutter (360) (width)	= internal width	+ 15
Roller Shutter (360) (height)	= internal height	+ 30
Aluminium Handle (364)	= internal width	- 20
Handle Cover (365)	= internal width	+ 4

## Installation

### STEP 3

#### Installing the Roller Shutter

##### Roller Shutter door with 90° Corner Track

