

Sliding Barn Door with Soft Close

STEP 11: Install soft close mechanism

1. Pull the slider of the soft close mechanism back to the end until it locks
2. Mark the top of the door at the halfway point of the door width
3. Centralise the soft close mechanism on the top of the door
4. Secure to the door using wood screws.

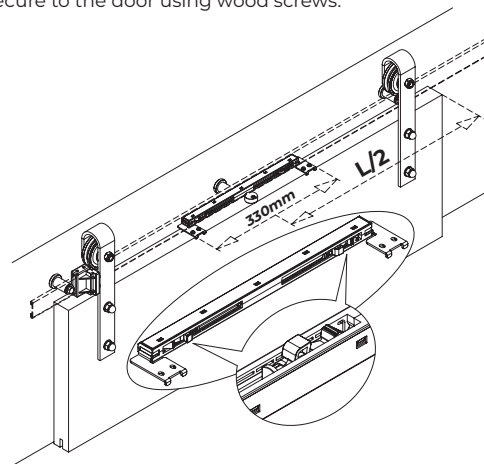

STEP 12: Install actuator

1. Move the door to closed position. Insert the actuator into the groove on the soft close.
2. Screw the actuator into place using the M5 x 6 self tapping screws provided.
3. Move the door stopper to make contact with the hanger. Tighten the hex screws.
4. Move the door to the open position, and repeat 1 - 3 above.

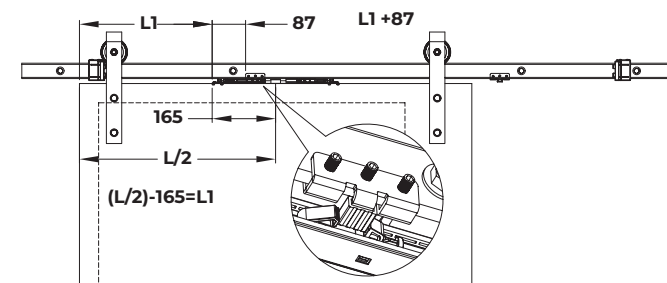

STEP 13: Activate anti-jump pad

1. Swing the anti-jump pad back into position and tighten it on the door. It can help prevent the door falling down from the track.

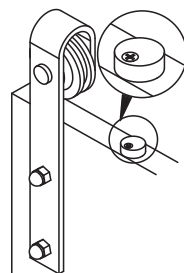

STEP 14.1: Install floor guide (router option)

(This is the floor guide option that required you to cut out a floor guide channel with a router as shown in Step 5)

1. When the door is in the open position, place the floor guide (components listed as floor guide 1) half way into the door slot.
2. Ensure the door is straight
3. Hold the door guide firmly in position and mark centers in the middle of both floor guide holes.
4. Use a "6mm" drill bit to drill 2 holes on the floor at the centers you have marked.
5. Put the plastic expansion nails into both of the holes.
6. Hold the floor guide firmly in place, install the screws to secure your floor guide to the floor using a drill with a Philips bit.

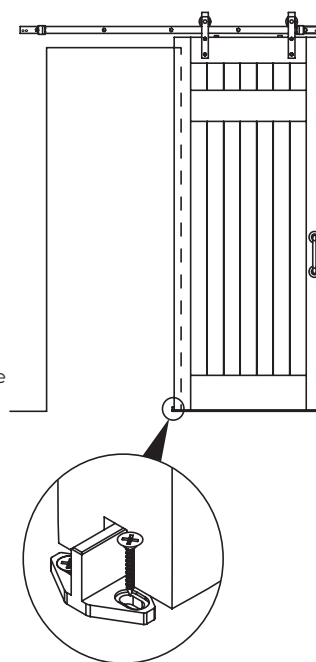

STEP 14.2 : Install floor guide (no router option 1)

(If you do not have access to a router, skip Step 5 and Step 14.1, and use the floor guide components listed as floor guide 2. Install the floor guide to the floor in front of the door.)

1. Open the door and ensure it is straight
2. Hold the floor guide firmly in position and mark the 4 floor guide holes.
3. Use a "6mm" drill bit to drill 4 holes on the floor as marked
4. Put the plastic expansion nails into the 4 holes.
5. Hold the floor guide firmly in place, install the screws to secure your floor guide on to the floor using a drill with a Philips bit.

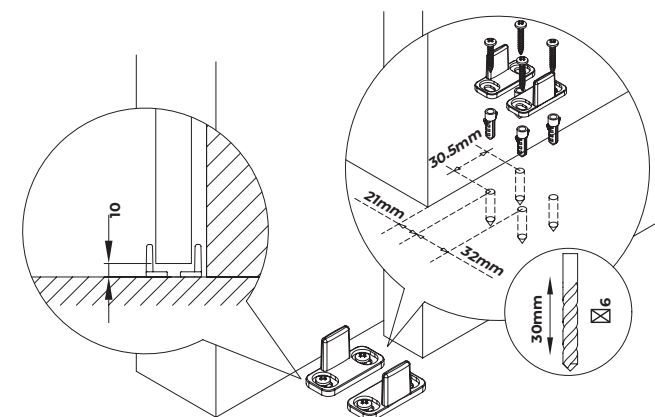

STEP 14.3: Install floor guide (no router option 2)

(If you do not have access to a router, and you do not want to install the floor guide to the floor, skip Step 5, Step 14.1, and Step 14.2 and use the floor guide components listed as floor guide 3. Install the floor guide to the base of the door.)

1. Open the door and ensure it is straight
2. Hold the floor guide firmly in position and mark the 2 screw holes on the side of the door
3. Use a "6mm" drill bit to drill 2 holes on the side you have marked.
4. Put the plastic expansion nails into both of the holes.
5. Hold the floor guide firmly in place, install the screws to secure your floor guide on to the side wall using a drill with a Philips bit.
6. Inset the other side component according to the thickness of the door. Screw to tighten.

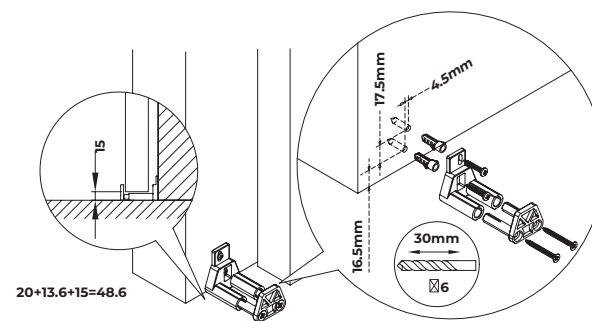

STEP 15: Install the stopper

1. Move the door to the left side and install / adjust the stopper (L) to touch with the hanger body;
2. Use the provided 3mm key, gently tighten the hexagonal screws on stopper.
3. Move the door to the right side and repeat steps 1 and 2 above to install the other side stopper (R).

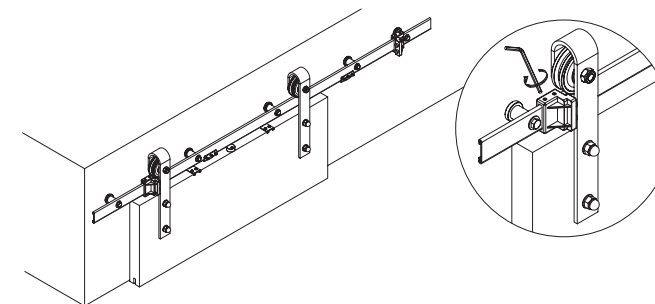

Barn Door Fittings

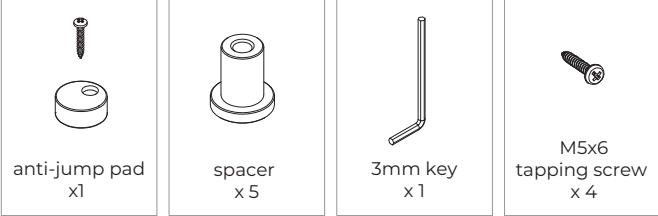
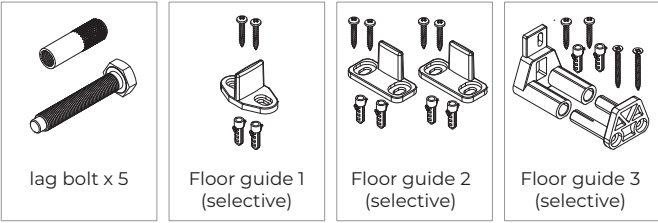
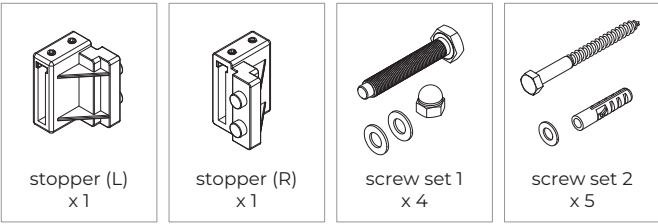
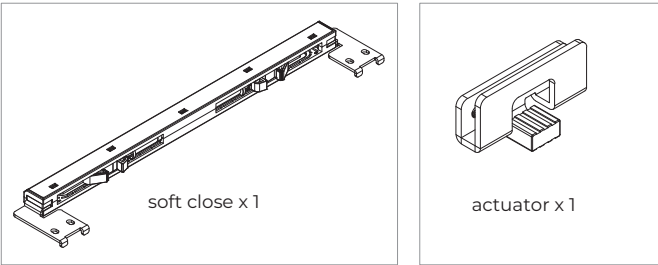
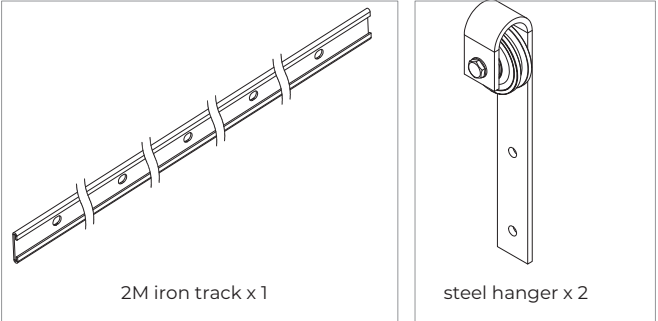

Tools Required:

Socket Wrench, Spirit Level, Measuring Tape, Pencil, Router*, Spanner & Drill
*If you do not have a router, see point 14.2 / 14.3 as alternate fitting options.

Door Specs:

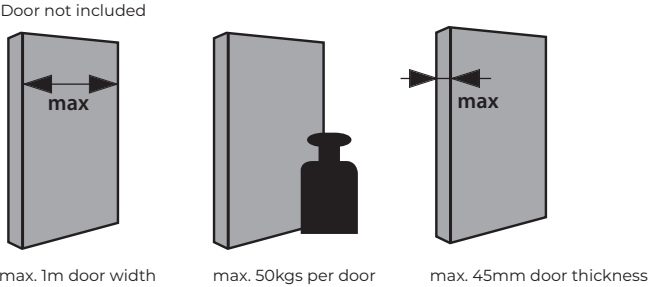

Installation:

STEP 1: Mark out the track position

1. Check if your floor is level. If not, do the below measurements from the highest point of your floor.
2. Draw a horizontal pencil line on the wall to mark the placement of the track. Measurement for this will be:
33.6mm + door height + 10mm for selective 14.1 /14.2 or
33.6mm + door height + 15mm for selective 14.3
3. Ensure the horizontal pencil line is the same length as the track, so you can easily find the track hole centre position to attach the track to your wall in the following steps.

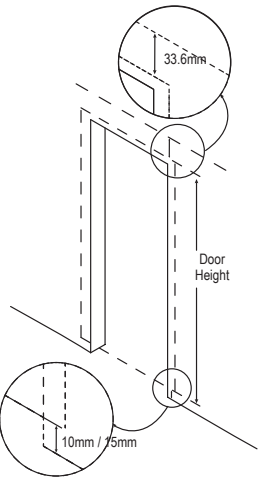

STEP 2: Mark out the track holes

1. Hold up the track so that the marked line from Step 1 will be visible through the track holes.
2. Mark an intersecting line in the centre point of each track hole.
3. Set the track down.
4. Drill out the marked track holes using a drill with a 12mm drill bit (selective 2.1) or for a lag bolt, drill with a 10mm drill bit (selective 2.2). If the wall is wooden, you don't need to drill holes.

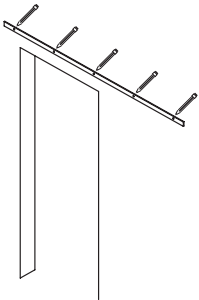

STEP 3: Attach the track to the wall

1. Put the door stoppers on the ends of the track. Do not tighten them.
2. Loosely attach the end of the track to the wall using the adjustable spacer and lag bolts.

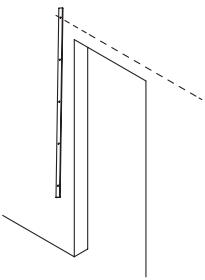

STEP 4: Install the track

1. Swing the track up to a horizontal position, and repeat Step 3 on the other end of the track.
2. Repeat on all remaining middle track holes.
3. Fully tighten all the bolts with your wrench after they are all in. Be careful not to make it too tight and strip the wall studs off.
4. Now you have installed the track on the wall successfully.

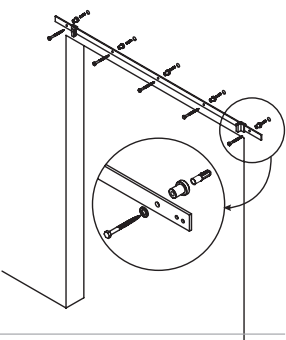

STEP 5: Prepare the door

1. For selective 14.1, cut a channel (7mm wide, 20mm deep) at the bottom of the door with a router. It will be used for installing the floor guide.

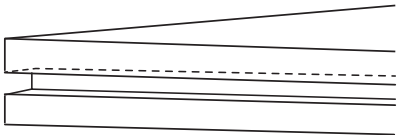

STEP 6: Position the hangers

1. Lay the door face up. Measure the distance from the door stopper on the rail to the end of the rail. Use this measurement to pencil a line parallel to the door edge.
2. Line up the hanger along the line you made.
3. Hold the hanger in place. The distance from the top edge of the door to the first hole is 38mm. The distance from the top edge of the door to the second hole is 128mm, (making the distance between the 2 holes 90mm).
4. Mark the center of both hanger holes.
5. Repeat this for the hanger on the opposite edge of the door.

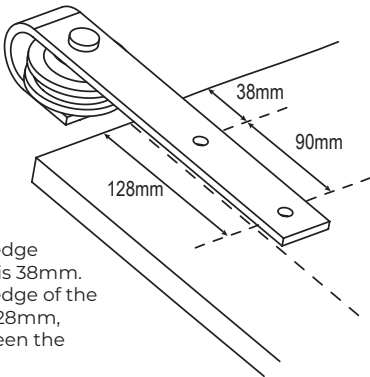

STEP 7: Drill the hanger holes

1. Drill a hole all the way through the door using a 10mm drill bit at the center of the 2 marks you that you had made at Step 6. Ensure you drill straight and sand down any rough edges
2. Repeat this for the other hanger on the opposite edge of the door.

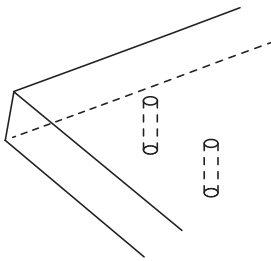

STEP 8: Install the hangers

1. Thread the hex bolt with the washer through the back of the door.
2. Place the acorn nut on the thread of the hex bolt. Hold the hex bolt in place using a wrench and tighten the acorn nut by hand.
3. Using another wrench for the acorn nut, gently tighten. Be careful not to damage your hanger or acorn nut.
4. Repeat this for the other hanger on the opposite edge of the door.

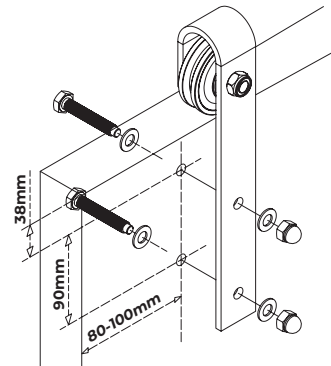

STEP 9: Install anti-jump pad

1. Place the anti-jump pad on the top of the door in the middle. Loosely attach the anti-jump pad to the door with a wood screw.
2. Swing it to the other side so that you can hang the door on the track.

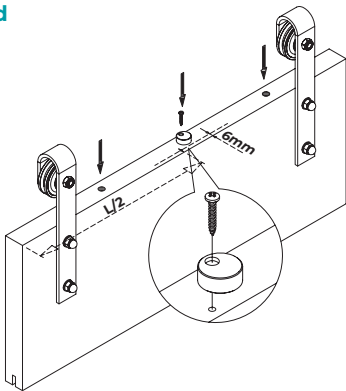

STEP 10: Place door on the track

1. Lift the door up to the track at a slight angle and carefully rest both wheel grooves onto the top of the track.

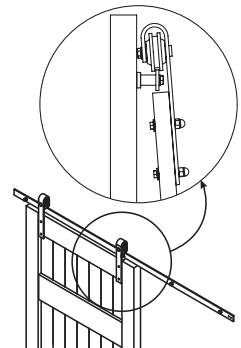

Disclaimer: If this product is not installed according to these specifications, Gelmar will not be liable for any damages.