

Installation

Step 1:

Assemble the left and right slide on both sides of cabinet

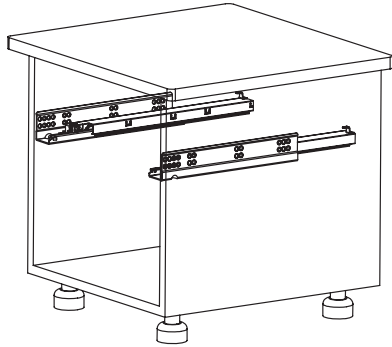

Step 3:

Lay drawer bottom onto the slide then push the drawer into the cabinet.

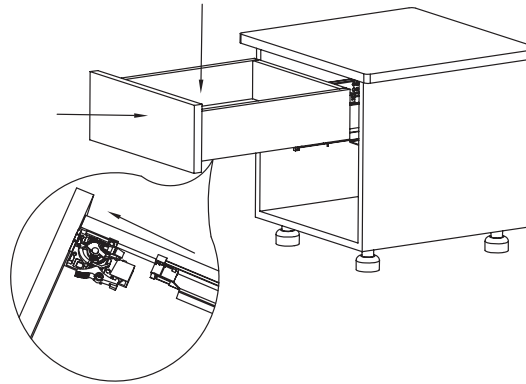

Step 2:

Assemble the handle on the bottom cabinet

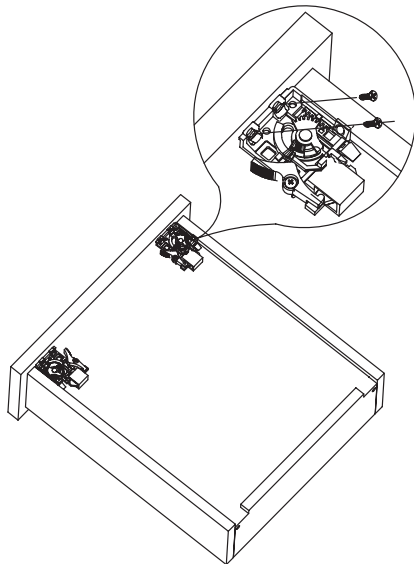

Step 4:

Push the drawer damping closed

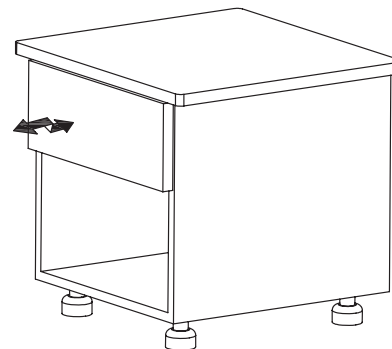

DIY Installation Guide

Undermount Runner with Push Open



Gelmar

Undermount Runner - Push Open

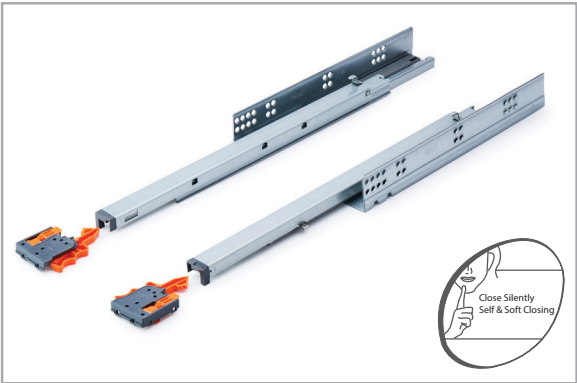

- ¾ Extension, Self Closing
- Easy Installation
- Front bracket adjustment ±2mm
- We recommend the use of 6x16 Undercut Screws

Hole Pattern for Installation

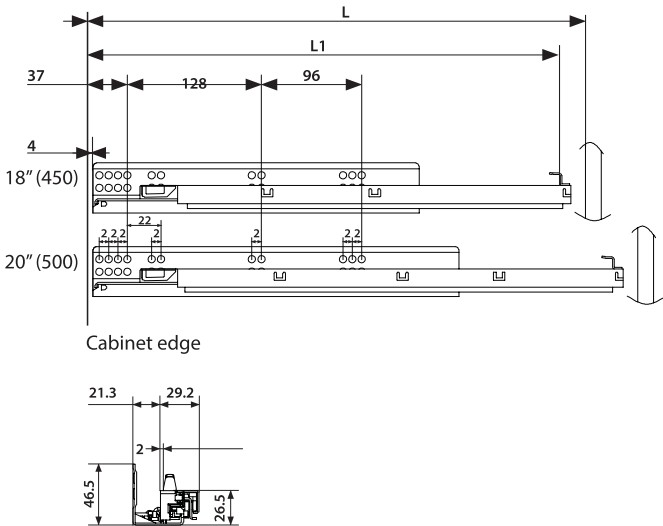

| Item No. | Slide Length | Drawer Length (L1) | Pull-out Length | Min. Cabinet Depth (L) |
|----------|--------------|--------------------|-----------------|------------------------|
| 7045 | 457mm | 450mm | 435mm | 472mm |
| 7046 | 507mm | 500mm | 485mm | 522mm |

Drawer Construction

Drawer Front View

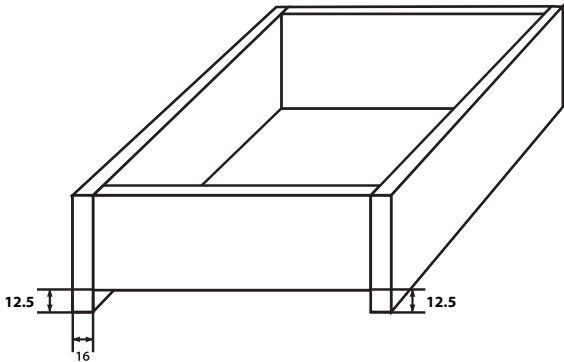

Drawer Back View

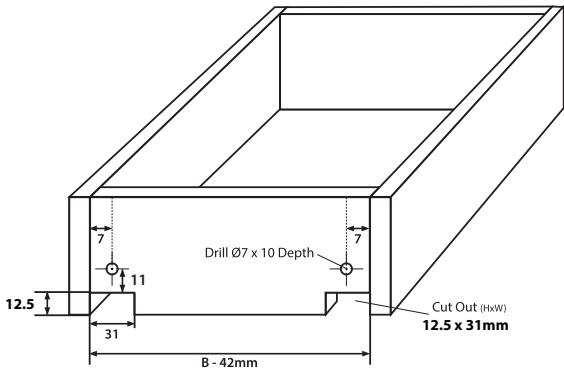

Drawer Construction

Standard Drawer

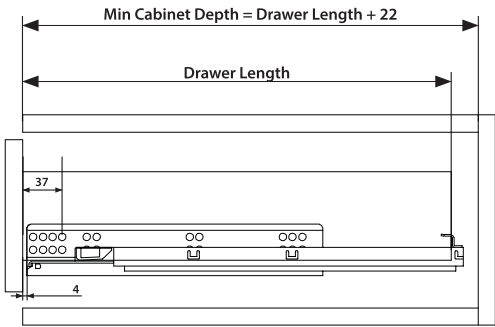

Inner Drawer

