

## Installation

### Step 1:

Assemble the left and right slide on both sides of cabinet

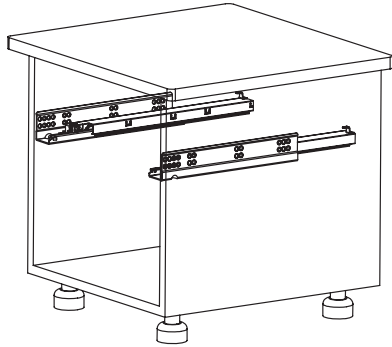

### Step 3:

Lay drawer bottom onto the slide then push the drawer into the cabinet.

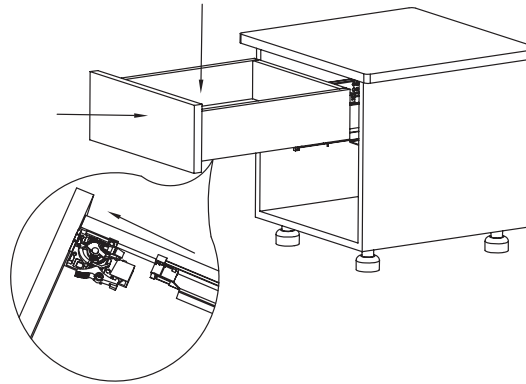

### Step 2:

Assemble the handle on the bottom cabinet

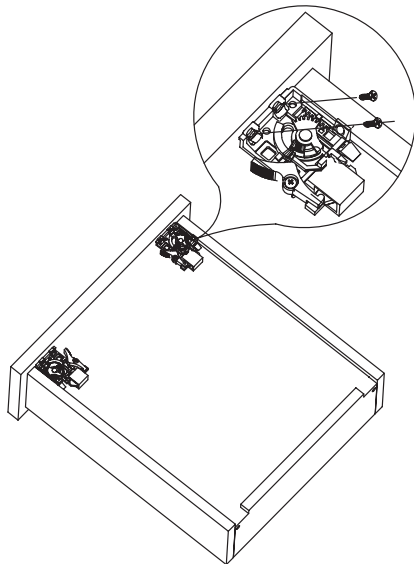

### Step 4:

Push the drawer damping closed

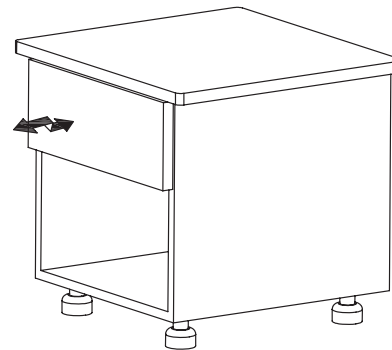

DIY Installation Guide

## Undermount Runner with Soft Close



Gelmar

Undermount Runner With Soft Close

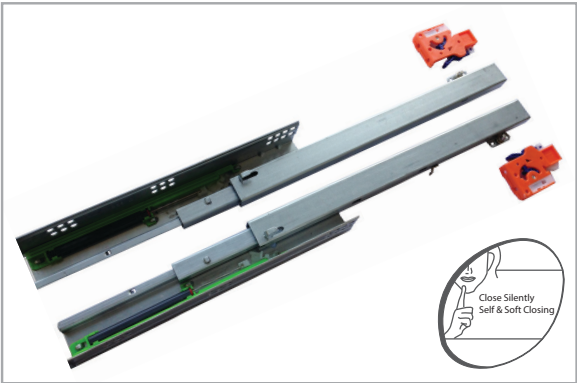

- ¾ Extension, Self Closing
- Easy Installation
- Front bracket adjustment ±2mm
- We recommend the use of 6x16 Undercut Screws

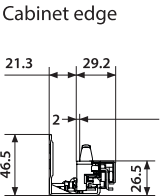

Hole Pattern for Installation

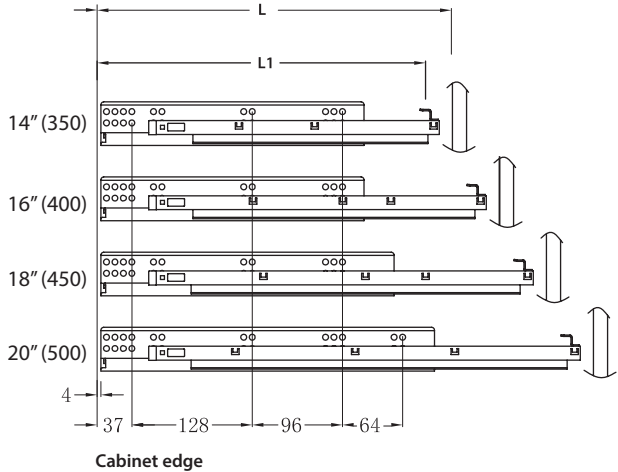

Item No.	Slide Length	Drawer Length (L1)	Pull-out Length	Min. Cabinet Depth (L)
7064	360mm	350mm	332mm	372mm
7071	410mm	400mm	382mm	422mm
7060	457mm	450mm	435mm	472mm
7061	507mm	500mm	485mm	522mm

Drawer Construction

Drawer Front View

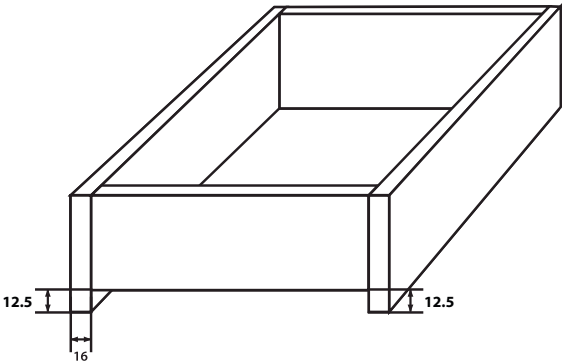

Drawer Back View

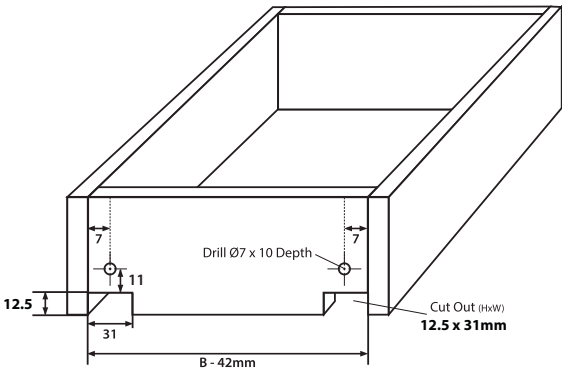

Drawer Construction

Standard Drawer

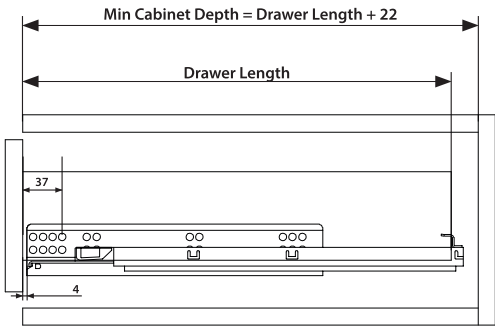

Inner Drawer

